



Sliding Pocket Door System without the need for architraves

Clean, contemporary and minimalist - when all you want to see is wall/door/wall.
The Sintesis Line has extra strengthening flanges at crucial points to guarantee a long lasting finish with no plaster cracking. We have paid particular attention to ensure this is the strongest system of this type on the market, a little more expensive but its worth it in the long run!



AVAILABLE ACCESSORIES

THE PERFECT FINISH



Vitro

Adapter for all-glass doors with stainless steel veil, accessories for stop jamb and brush holder in aluminum coated with paintable PVC, see page 55



Door Furniture

Simple Flush Pulls and Bathroom furniture, see page 44



No architraves and a plaster finish all round the door opening for the perfect aesthetic.

finished wall thickness **100** mm

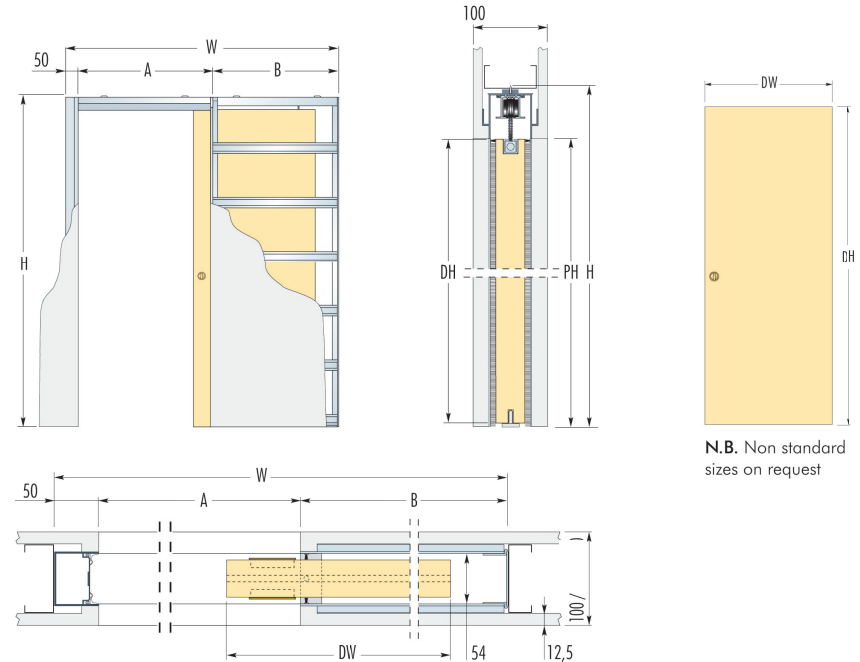

N.B. Non standard sizes on request

PS. The top of the door should be routed as indicated.

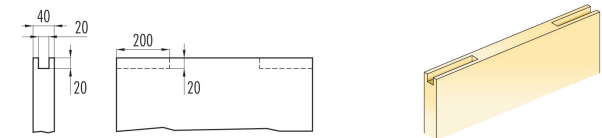

FRAMES FOR SINGLE DOORS				Finished Wall	DOOR PANEL UK		NOTES
Clearance A x PH	L	B	Overall Dimension W x H		Standard DW	DH	
600 x 2048	520	735	1385 x 2108	100	626	2040	Suitable for door thickness 35 to 40 mm Max door weight 80kg. When fitting flush pull handles we recommend the track stop to be positioned so the door protrudes from the pocket to avoid risk to fingers. Should the door be adjusted to retract fully into the pocket we do not accept any liability.
700 x 2048	620	835	1585 x 2108	100	726	2040	
800 x 2048	720	935	1785 x 2108	100	826	2040	
900 x 2048	820	1035	1985 x 2108	100	926	2040	
1000 x 2048	920	1135	2185 x 2108	100	1026	2040	
584 x 1989	504	735	1369 x 2049	100	2ft. 0in. x 6ft. 6in. (610 x 1981mm)	2040	Doors, plasterboard and plaster not supplied
660 x 1989	580	835	1545 x 2049	100	2ft. 3in. x 6ft. 6in. (686 x 1981mm)	2040	
736 x 1989	656	935	1721 x 2049	100	2ft. 6in. x 6ft. 6in. (762 x 1981mm)	2040	
812 x 1989	732	935	1797 x 2049	100	2ft. 9in. x 6ft. 6in. (838 x 1981mm)	2040	
888 x 1989	808	1035	1973 x 2049	100	3ft. 0in. x 6ft. 6in. (914 x 1981mm)	2040	

dimensions are given in mm.